

EL-HUB SETUP START HERE

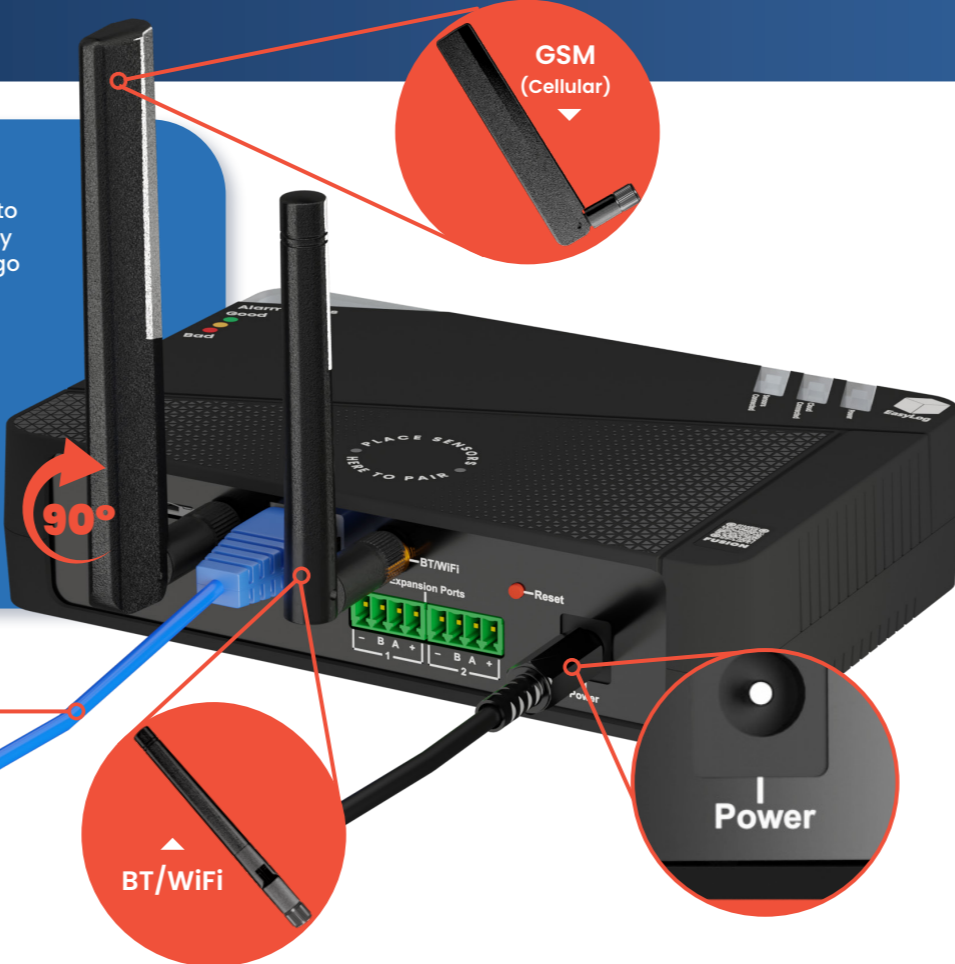

Before you begin

- 1 You'll need an EasyLog Cloud account to set up your Fusion System. If you already have a Cloud account, log in, or if not, go to easylogcloud.com and sign up.
- 2 Once you have an account you will also need to download the App version to your mobile device. The Android App is available from Google Play and the iPhone version for iOS from the Apple App Store. Search for "EasyLog Cloud".



An Ethernet cable can be used for communications and also to power a Hub (POE).

Connect the Hub

- 3 With the Hub, supplied antennas and power supply to hand you now need to connect the Hub with its communication and power sources.

Take the two antennas and screw them clockwise into the port marked "BT/WIFI" and "GSM" until they are "Finger Tight".

The antennas can be angled up to 90° to suit your preferred mounting location.

- 4 There are two options for powering a Hub. Either:

a, Plug-in the power cable by Inserting the DC plug end into the port marked "POWER" on the rear of the Hub. Plug the other end of the cable into a mains power outlet and switch on.

b, Use an Ethernet cable to provide power. Insert the cable into the port marked "ETH" on the Hub and the other end into a suitable LAN outlet.

- 5 The Hub's lights will cycle Red, Amber and Green 3 times and then settle with just the Power and Connected lights lit. This confirms if the Hub is ready to be added to your Cloud Account.



1st time App Users

If using the Cloud App for the 1st time, the 1st screen you will see is the "Add your 1st device" Press the Hub button to continue.

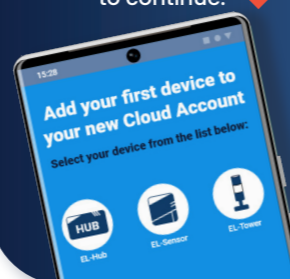

Follow the instructions within the App to complete adding the Hub to your Cloud Account. Once done, you are ready to add Sensors to your Fusion System.

Existing App Users

If you have used the App before then go to the Main Menu and select Setup. Now you can press the Hub button to continue.

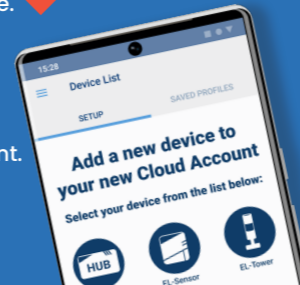

Visit lascarelectronics.com/fusion for the full user manual and more information

YOUR EL-HUB

- 1 Hub status light
- 2 Sensor pairing area
- 3 Sensors connected light
- 4 Cloud connected light
- 5 Power status light
- 6 Air vents
- 7 Product label
- 8 VESA mounting holes
- 9 Wall mounting screw holes
- 10 Sim card slot (GSM only)

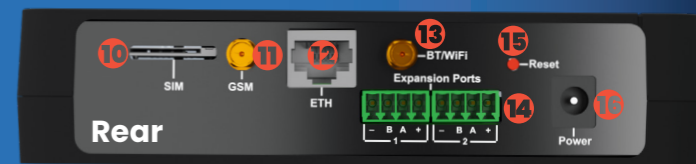
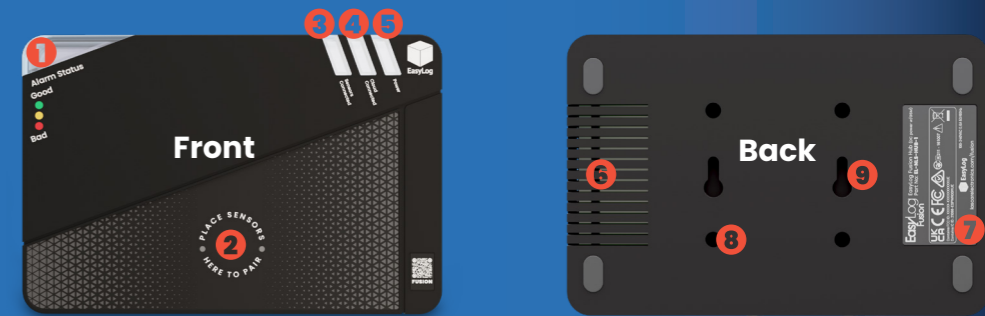

- 11 GSM antenna and port
- 12 Ethernet cable and port
- 13 BT/WiFi antenna and port
- 14 Expansion ports
- 15 Reset button
- 16 DC power cable and port



WIRELESS SENSOR SETUP



- 1 Choose how you want to power your sensors, by battery or with a USB C cable.

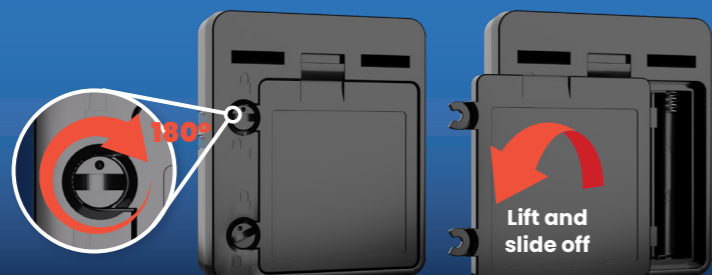

Power by battery

Remove the battery cover on the rear of the sensor by turning the two locks 180° and then lift off.

Insert 4 x AAA batteries and then replace the battery cover.

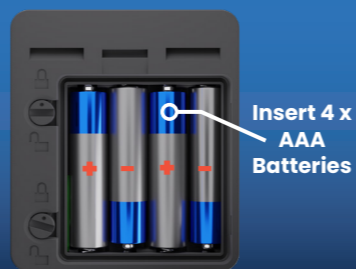

Power by USB C cable

Insert a USB C cable into the USB port on the bottom of sensor and connect the other end to a suitable power supply.



- 2 To pair your Sensor to a Hub, line up the pairing icons on the front faces of both devices.

Simply touch your sensor to the Hub. Both your Hub and sensor will flash green lights to indicate that they are now paired.

Sensor pairing icon

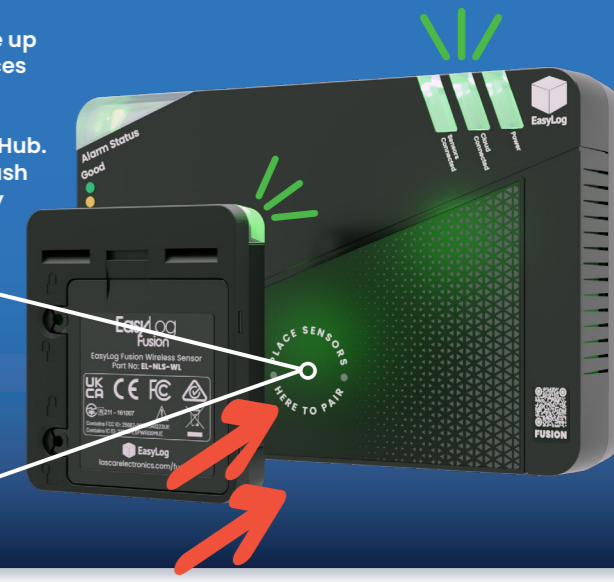

WIRED SENSOR SETUP

Wired Sensors are connected to their Hub using a daisy-chain layout. The cable used carries both power and data. Each Hub has two connectors, so two daisy-chains can be supported.

As soon as each Sensor is connected to the Hub, it is automatically paired and will start operating.

We recommend using CAT 5 cable for installation

There is no limit to the number of Sensors you can connect on each daisy-chain, other than the total limit of 20 Sensors for each Hub, which can be any mixture of Wireless and Wired Sensors that you need.

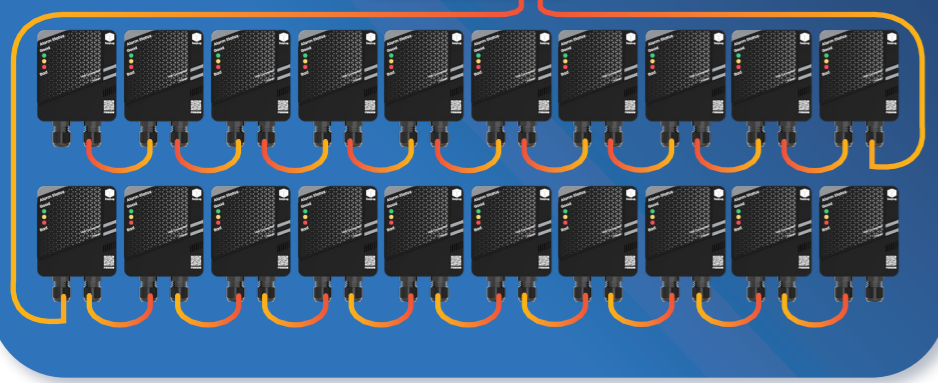

1 Sensor Wiring

Remove the 4 screws holding the wall mount cover in place and lift it off to reveal the wiring bay.

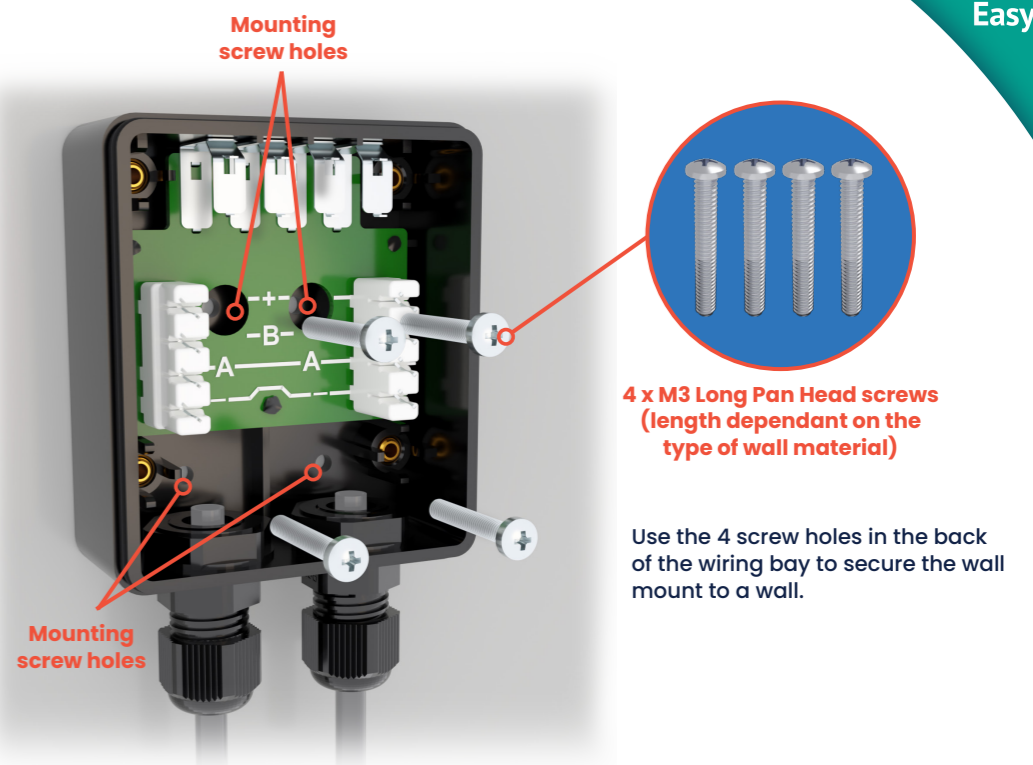
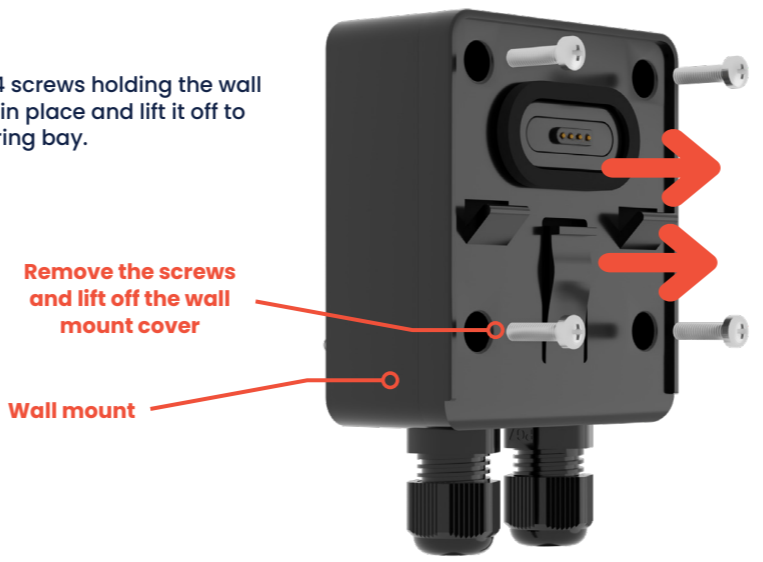

2

Loosen the cable gland screws and feed the cables into the Sensor.

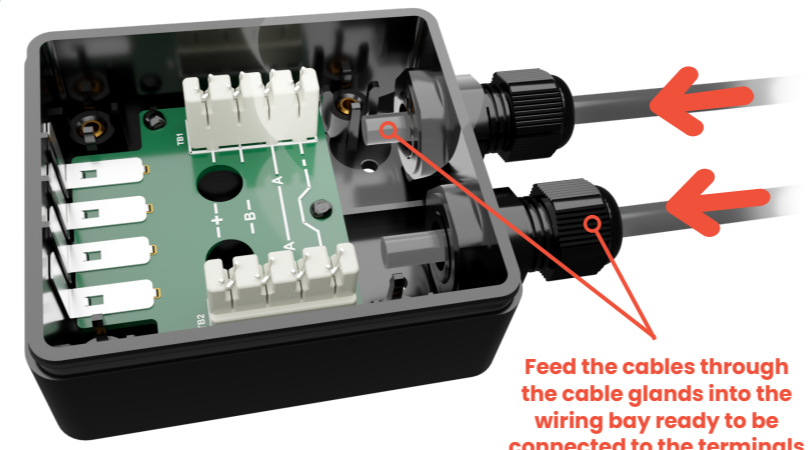

4 Wiring a Sensor to a Hub

The opposite end of the two cables need to be wired into x2 4-way pluggable terminal blocks. The same wire groups as are connected into the sensor also apply here (see diagram right). Those terminal blocks should then be plugged into the Expansion ports.

When power is applied to the hub it will automatically pair with the sensors that have been connected to it. Both your Hub and sensor will flash green lights to indicate that they are now paired.

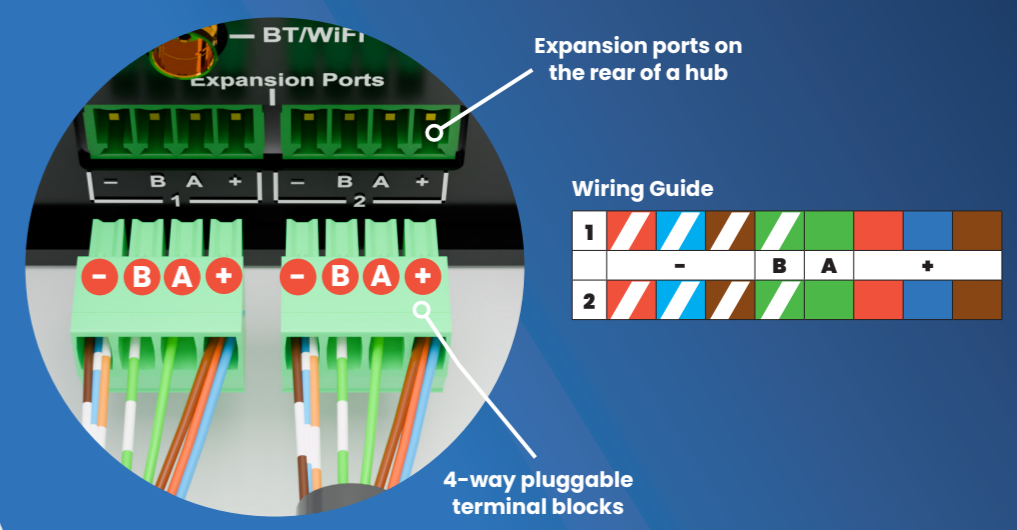

3

Connect the wires from the cable into both terminals (optional depending on single or multiple sensors in use).

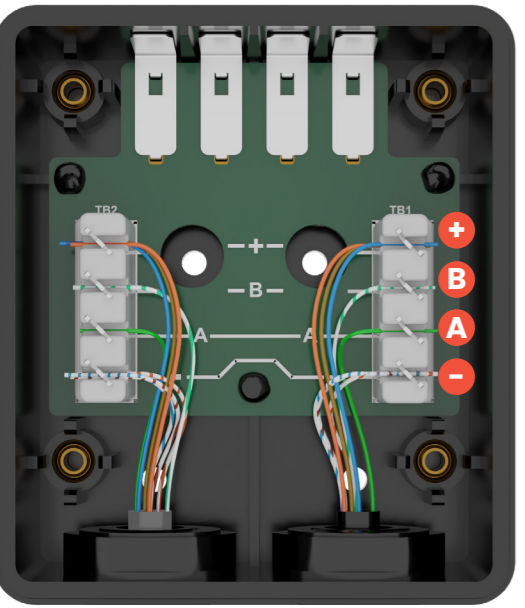

Connect wires in the following order:

- +** Solid orange, blue and brown
- B** Green and white stripes
- A** Solid green
- Orange and white stripes, Blue and white stripes and Brown and white stripes

Wiring Guide

1	+	B	A	-
2	+	B	A	-

Replace the wall mount cover and screws and then reattach the sensor to the wall mount.

